



Model #AGM-78

Cooling

Temperature Range	33°F-40°F
Refrigerant	R290
Max. Ambient Temperature	90°F
Defrosting	Automatic
Temperature Controller	Digital
Horsepower	4/5

Electrical

Voltage	115
Amps	8.4
Hz	60
Phase	1
Plug Type	NEMA-5-15P
Electrical Cord Length	98"

Standard Features – Glass Door Refrigerator Model #AGM-78

- (3) self-closing swing glass doors
- Interior LED lighting
- (12) epoxy-coated steel shelves included
- Simple installation with no plumbing
- Easily accessible condenser coil for cleaning and easy service access
- Bottom mount condensing unit
- Removable door gasket for easy cleaning
- Automatic defrosting
- Stainless steel floor
- Copper evaporator
- Eco-friendly R290 hydrocarbon refrigerant
- 5" Casters
- ETL listed. Conforms to UL STD. 471, Certified to CSA STD. C22.2No.120
- Conforms to NSF/ANSI STD. 7

Construction

Exterior Material	Powder Coated Cold Rolled Steel
Interior Material	Painted Aluminum
Door Type	Glass Swing
Insulation Material	Foamed-In-Place Polyurethane
Shelf Sizes	(8) R&L 23.2" x 23" (4) 25.8" x 23"
Material	Epoxy-Coated Steel
Shelf Load Capacity	88 lbs.

Dimensions

Exterior Dimensions	78.3"W x 30"D x 84.6"H
Interior Dimensions	73.5"W x 23.6"D x 59.7"H
Shipping Dimensions	81"W x 33"-3/4"D x 87-1/2"H
Net Volume	58.2 cu. ft.
Net Weight	615 lbs.
Gross Weight	672 lbs.



PLAN VIEW

Front View

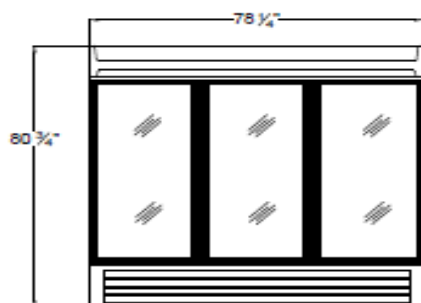

Side View



Top View

