



Model #AST-27M

Cooling

Temperature Range	33°F - 40°F
Refrigerant	R290
Max. Ambient Temperature	90°F
Defrosting	Automatic
Temperature Controller	Digital
Horsepower	3/7

Electrical

Voltage	115
Amps	3.6
Hz	60
Phase	1
Plug Type	NEMA-5-15P
Electrical Cord Length	96"

Standard Features - Mega Top Salad Prep Table #AST-27M

- Eco-friendly R290 hydrocarbon refrigerant
- Sleek, stainless steel interior and exterior
- 29" Mega Top
- Top holds up to (6) 1/6 size and (2) 1/9 size, 6" deep food pans, and cutting boards (sold separately)
- Insulated lid helps maintain safe product temperatures
- Single self-closing swing door with recessed handles
- Equipped with casters
- 27.9 cu. ft.
- 115V, 3/7hp, 3.6 amps
- Conforms to NSF/ANSI STD.7.
- ETL Safety & Sanitation Listed

Construction

Exterior Material	430 Stainless Steel
Interior Material	430 Stainless Steel
Insulation Material	Foamed-In-Place Polyurethane
Shelf Size	(1) 23.5"W x 17.1"D
Shelf Material	Epoxy-Coated Steel
Shelf Load Capacity	88 lbs.

Dimensions

Exterior Dimensions	27.5"W x 34"D x 45.9"H
Interior Dimensions	24.2"W x 19.8"D x 23.5"H
Shipping Dimensions	31-3/4"W x 39-1/4"D x 49"H 35-1/4"
Working Height	35-1/4"
Overall Height (Lid Open)	47-1/4"
Cutting Board Dimensions	47-1/4"27-1/4"W x 8"D x 3/4"H
Net Volume	7.9 cu. ft.

Net Weight	187 lbs.
Gross Weight	251 lbs.

Pan Capacity	(9) 1/6 Size + (3) 1/9 Size
--------------	-----------------------------



Parts & Labor

Compressor

PLAN VIEW

Front View

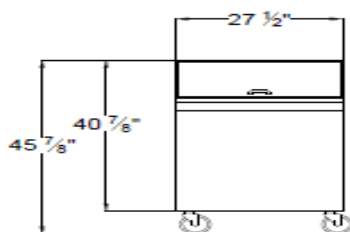

Side View

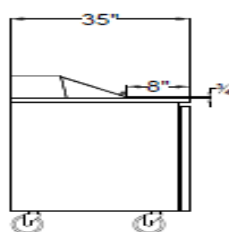

Top View

