



Model #AST-36

Standard Features - Salad Prep Table #AST-36

- Eco-friendly R290 hydrocarbon refrigerant
- Sleek, stainless steel interior and exterior
- Top holds up to (10) 1/6 size, 6" deep food pans (sold separately)
- Full length, 10-1/2" deep cutting board, 3/4" thick
- Insulated lid helps maintain safe product temperatures
- Double self-closing swing doors with recessed handles
- Equipped with casters
- 115V, 3/7 hp, 4.3 amps
- ETL listed. Conforms to UL STD. 471, Certified to CSA STD. C22. 2No.120
- Conforms to NSF/ANSI STD. 7.

Construction

Exterior Material	430 Stainless Steel
Interior Material	430 Stainless Steel
Insulation Material	Foamed-In-Place Polyurethane
Shelf Size	(2) 15.8"W x 17.1"D
Shelf Material	Epoxy-Coated Steel
Shelf Load Capacity	88 lbs.

Cooling

Temperature Range	33°F - 40°F
Refrigerant	R290
Max. Ambient Temperature	90°F
Defrosting	Automatic
Temperature Controller	Digital
Horsepower	3/7

Dimensions

Exterior Dimensions	36.2"W x 29.5"D x 42.3"H
Interior Dimensions Ship	33"W x 19.8"D x 23-1/2"H
Dimensions Overall	40-1/2"W x 33-3/4"D x 45-1/2"H
Height (Lid Open)	47-1/4"
Cutting Board Net	33-7/8"W x 8"D
Volume	10.8 cu .ft.
Net Weight	242 lbs.
Gross Weight	286 lbs
Pan Capacity (10) 1/6 Size	

Electrical

Voltage	115
Amps	4.3
Hz	60
Phase	1
Plug Type	NEMA-5-15P
Electrical Cord Length	96"



Parts & Labor

Compressor

PLAN VIEW

Front View

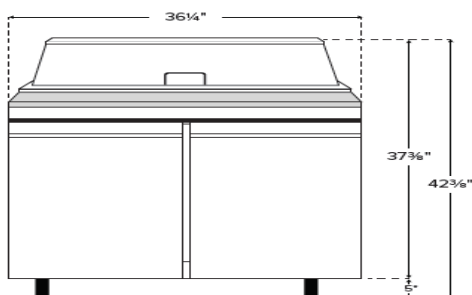

Side View

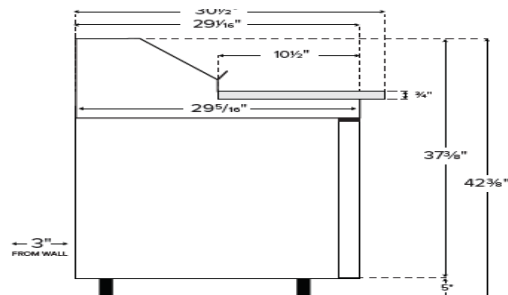

Top View

