



Model #AST-72M

Standard Features - Mega Top Salad Prep Table #AST-72M

- Sleek, stainless steel interior and exterior
- Eco-friendly R290 hydrocarbon refrigerant
- Top holds up to (30) 1/6 size, 6" deep food pans (sold separately)
- Full length, 8" deep cutting board, 3/4" thick
- Insulated lid helps maintain safe product temperatures
- Three self-closing swing doors with recessed handles
- Pan rail is air cooled from the bottom
- Equipped with casters
- 21.8 cu. ft.
- 115V, 4/5 hp
- ETL Safety & Sanitation Listed

Construction

Exterior Material	430 Stainless Steel
Interior Material	430 Stainless Steel
Insulation Material	Foamed-In-Place Polyurethane
Shelf Size	(3) 21.6"W x 17.1"D
Shelf Material	Epoxy-Coated Steel
Shelf Load Capacity	88 lb.

Cooling

Temperature Range	33°F - 40°F
Refrigerant	R290
Max. Ambient Temperature	90°F
Defrosting	Automatic
Temperature Controller	Digital
Horsepower	4/5

Dimensions

Exterior Dimensions	70-4"W x 34.0"D x 45-9"H
Interior Dimensions	66.6"W x 19.8"D x 23.5"H
Shipping Dimensions	74-3/4"W x 39-1/4"D x 49"H
Working Height	35-1/4"
Overall Height (Lid Open)	51-3/4"
Cutting Board Dimensions	70-3/8"W x 11-1/2"D x 3/4"H
Net Volume	21.8 cu. ft.

Net Weight	528 lbs
Gross Weight	576 lbs.

Pan Capacity	(30) 1/6 Size
--------------	---------------

Electrical

Voltage	115
Amps	7.8
Hz	60
Phase	1
Plug Type	NEMA-5-15P
Electrical Cord Length	96"



PLAN VIEW

FRONT VIEW

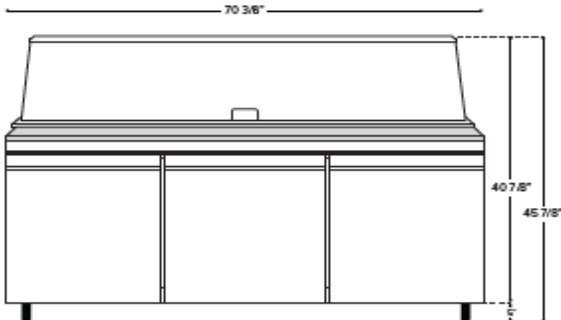

SIDE VIEW

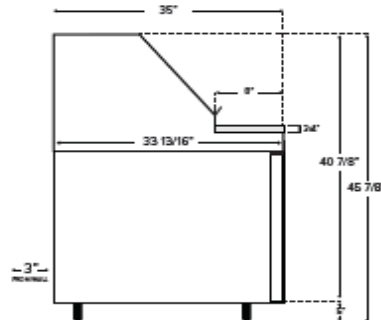

TOP VIEW

