



Model #AGM-49F

Cooling

Temperature Range	-7°F-0°F
Refrigerant	R290
Max. Ambient Temperature	90°F
Defrosting	Automatic
Temperature Controller	Digital
Horsepower	1-2/7

Electrical

Voltage	115
Amps	9.4
Hz	60
Phase	1
Plug Type	NEMA-5-15P
Electrical Cord Length	98"

Standard Features – Glass Door Freezer Model #AGM-49F

- Two self-closing, anti-fog glass doors
- Interior LED lighting
- (8) epoxy-coated steel shelves included
- Simple installation with no plumbing
- Easily accessible condenser coil for cleaning and easy service access
- Bottom mount condensing unit
- Removable door gasket for easy cleaning
- Automatic defrosting
- Stainless steel floor
- Copper evaporator
- Eco-friendly R290 hydrocarbon refrigerant
- 5" Casters
- ETL listed. Conforms to UL STD. 471, Certified to CSA STD. C22. 2No.120

Construction

Exterior Material	Powder Coated Cold Rolled Steel
Interior Material	Painted Aluminum
Door Type	Glass Swing Doors
Insulation Material	Foamed-In-Place Polyurethane
Shelf Size	(8) 18-3/4" x 21-1/4"
Shelf Material	Epoxy-Coated Steel
Shelf Load Capacity	88 lbs.

Dimensions

Exterior Dimensions	49.2"W x 26.2"D x 84.6"H
Interior Dimensions	43.3"W x 121.3"D x 55.1"H
Shipping Dimensions	52"W x 31-1/2"D x 87"H
Net Volume	26.8 cu. ft.
Net Weight	393 lbs.
Gross Weight	463 lbs.



Parts & Labor

Compressor

PLAN VIEW

Front View

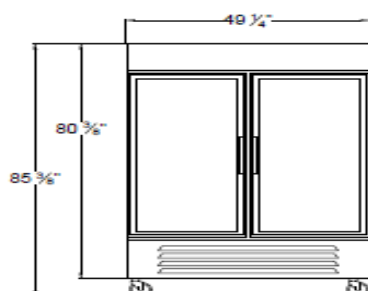

Side View

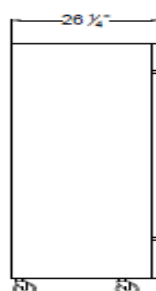

Top View

